

# GAC 5472-5A

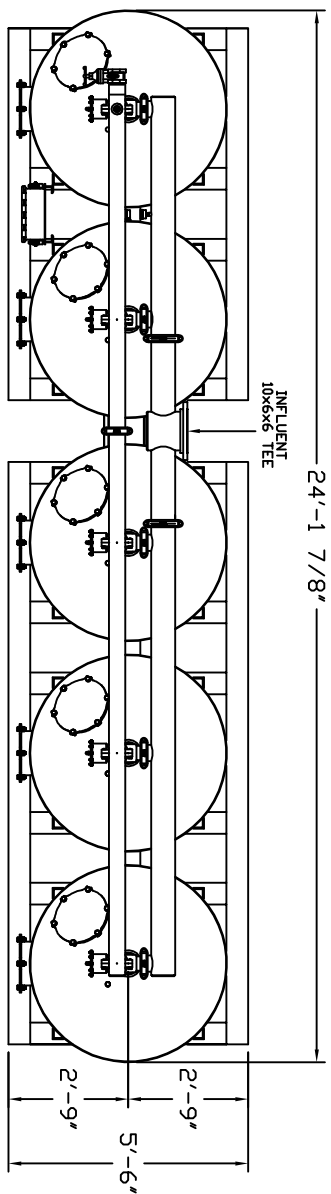

- NOTES:
1. FLOW RATE DESIGN: 400-800 GPM, MAX TD 1500 GPM, BACKWASH RATE: 10 GPM/FT<sup>2</sup>.
  2. MAXIMUM WORKING PRESSURE: 80 PSI.
  3. ELECTRICAL REQUIREMENTS: CONTROLLER 120V, SOLENOIDS 24VAC, FACTORY WIRED
  4. AIR SUPPLY REQUIRED: 2 CFM @ 70 PSIG (MIN).
  5. MEDIA REQUIREMENT PER TANK:
    - A. 1/2"x3/4" CRUSHED ROCK: 9.5 CU. FT.
    - B. GRANULAR ACTIVATED CARBON: 6.35 CU. FT.
  6. WEIGHTS: (APPROX)
    - EQUIPMENT: 7,490 LBS (LESS MEDIA)
    - MEDIA: 14,008 LBS
    - OPERATION: 42,000 LBS

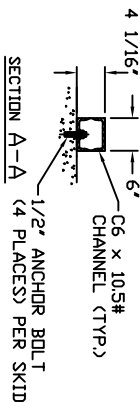
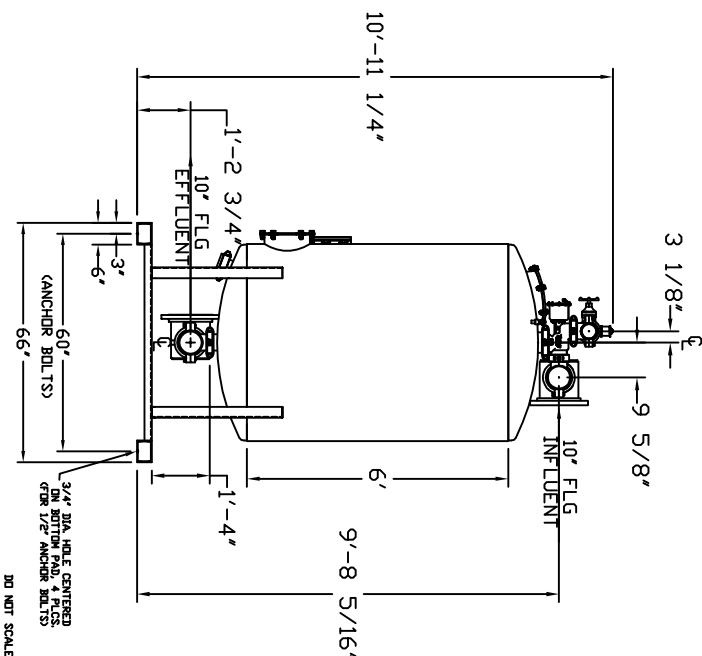
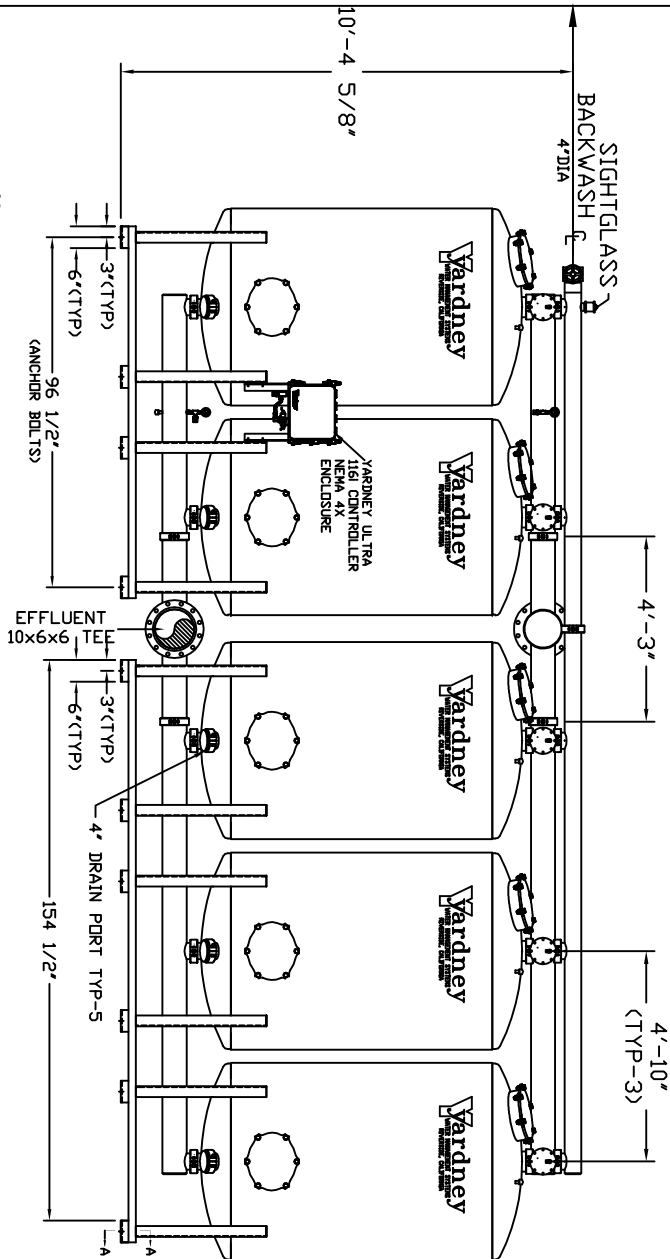

THIS DRAWING, INCLUDING THE INFORMATION IT CONTAINS, IS THE PROPERTY OF YARDNEY WATER MANAGEMENT SYSTEMS, INC. AND IS TO BE USED ONLY FOR THE PROJECT AND SITE SPECIFICALLY IDENTIFIED HEREIN. ANY REUSE OR MODIFICATION OF THIS DRAWING WITHOUT THE WRITTEN PERMISSION OF YARDNEY WATER MANAGEMENT SYSTEMS, INC. IS STRICTLY PROHIBITED. THE DRAWING IS NOT TO BE USED FOR ANY OTHER PROJECT OR WATER MANAGEMENT SYSTEMS, 1994.

**Yardney**  
WATER MANAGEMENT SYSTEMS, INC.

**GAC 5472-5A**  
FILTER SYSTEM

REV	DATE	BY	CHKD	DESCRIPTION
1	07/10/07	AVM	AVM	ISSUE FOR PERMIT
2	07/10/07	AVM	AVM	REVISED PER COMMENTS
3	07/10/07	AVM	AVM	REVISED PER COMMENTS
4	07/10/07	AVM	AVM	REVISED PER COMMENTS
5	07/10/07	AVM	AVM	REVISED PER COMMENTS

DO NOT SCALE DWG.